

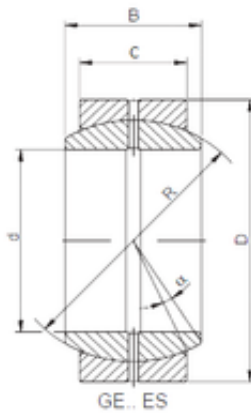

JOD Machinery Co., Ltd.

200 mm x 290 mm x 130 mm ISO GE 200 ES
plain bearings



Bearing No. GE 200 ES

Size	200x290x130 mm
Bore Diameter	200 mm
Outer Diameter	290 mm
Width	130 mm
d	200 mm
D	290 mm
B	130 mm
C	100 mm
R	250 mm
Angle	7 °

GE 200 ES Bearing 2D drawings and 3D CAD models