

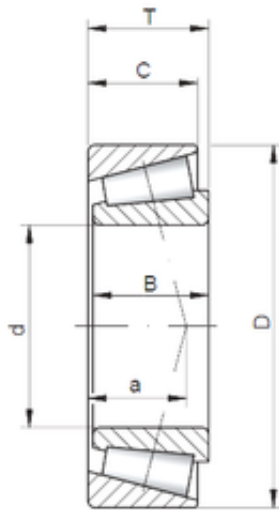

# JOD Machinery Co., Ltd.



127,792 mm x 228,6 mm x 49,428 mm ISO  
HM926749/10 tapered roller bearings

Bearing No. HM926749/10

Size	127.792x228.6x53.975 mm
Bore Diameter	127,792 mm
Outer Diameter	228,6 mm
Width	53,975 mm
d	127,792 mm
D	228,6 mm
T	53,975 mm
B	49,428 mm
C	53,975 mm
a	13,5 mm

HM926749/10 Bearing 2D drawings and 3D CAD models